



FILLING CLEAROMIZER

Do not overfill the Clearomizer

Do not inject more than 1.6ml of e-liquid to prevent leakage

Do not allow the e-liquid level to drop below 0.6ml to prevent damage

Do not inject liquid inside the central air-intake hole

The Clearomizer is a consumable product and lifespan is subject to individual usage. We recommend replacing the Clearomizer within 30 days of first use.

HOW TO INJECT E-LIQUID

Turn the mouthpiece cap counter-clockwise



Slide the mouthpiece cap away from the filling chamber



Carefully drip liquid down the side of the chamber, make sure to avoid the central air-intake hole



Replace the mouthpiece cap and allow liquid to settle for a minimum of 2 minutes before using

Getting Started

STEP 1: Remove components from packaging.

STEP 2: Screw the clearomizer onto the rechargeable battery.

STEP 3: Featuring Hold Charge™ battery technology. To activate battery from hibernation, rapidly press start button five times. To return battery to hibernation press button five times, maximizing battery life.



Use Battery With:
Cartomizer Vaping
Pre-Filled V-Tank™ Clearomizers
Fillable Vaping



Charging Battery

While ready to use right out of the box, to maximize battery life it is recommended to charge before first use.

STEP 1: Unscrew clearomizer from the battery.

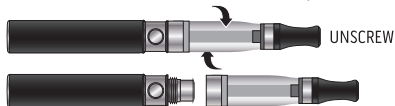

STEP 2: Screw the battery into the USB charger.

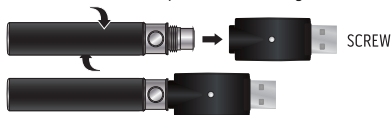

STEP 3: Insert the USB charger into any USB port. The charger LED will light red indicating that the battery is charging. The charger LED changes from red to green when the battery is fully charged.

STEP 4: Unplug the USB charger and unscrew the battery.

STEP 5: Twist clearomizer onto the charged battery.

STEP 6: Push the LED button and inhale to enjoy the vapor.

Please Note:

Do not leave battery unattended during charging.

Once clearomizer is secured to battery, keep in upright position to discourage leaking.

Store at room temperature away from direct heat.