

EMC cable glands with moving spring contact

**EMC 3 Cable Glands Brass****M40x1,5 / 19,0-28,0mm / TL=9,0mm****BMEM-E5**

- Specially designed EMC protective cable glands.
- Long-lasting contact by high definition contact spring.
- Moving spring contact offers reduced risk of sheath damage.
- Easy assembly: install cable gland - prepare cable sheath - insert cable - tighten cap.
- High quality strain relief and sealing, reliable performance for EMC applications.
- Up-to-date international approvals.

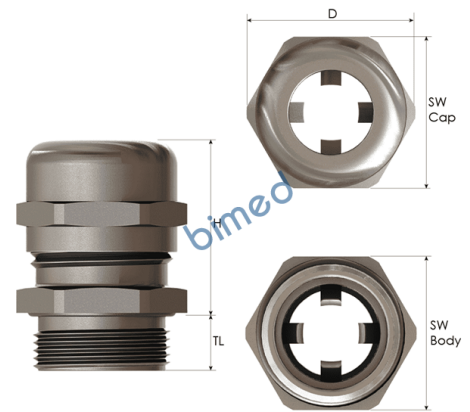

Images might not be representative of the actual colour, size or shape of the product listed

**TYPE 4X**

File Number	Standard
VDE_40039349	DIN EN 62444
E199260	UL514B, CSA22.2 No 18.3-12, CSA22.2 No 94.2-15 UL50E
TAE00003WY	EN62444
GOST	

**Technical Details**

<b>Material</b>	<b>Body , Cap</b>	Brass Nickel plated	
	<b>Seal</b>	CR ( Chloroprene )	
	<b>Clamping Insert</b>	PA 6 (Polyamide 6)	
	<b>Contact Spring</b>	Special Copper Alloy	
	<b>O-Ring</b>	NBR	
<b>Ingress Protection Rating</b>		IP 68 - 5 Bar, 30 min	
<b>UL Environmental Rating</b>		TYPE 4X acc. to UL 50E	
<b>Flammability</b>		V2 according to UL94	
<b>Operating Temperature</b>		<b>Permanent</b>	<b>Intermittent</b>
		-20 °C to +100 °C	-40 °C to +150 °C
<b>Thread Type</b>		Metric EN 60423	
<b>Cable Type</b>		Shielded	
<b>Accessories</b>		EMC Lock nuts	
		Dome plugs	
		Gaskets ( Washers )	
<b>Remarks</b>		In compliance with DIN EN 62444.	
		We recommend the use of lock nuts and gaskets to ensure IP rating for - rough surfaces or through holes.	
		Some approvals do not cover all sizes.	
		O-ring available in Metric and PG threads as a standard. For NPT - threads O-ring available upon request.	
		Accessories must be ordered separately.	
		Other lock nut types also available upon request.	
<b>Outer</b>	<b>Thread Size (Male)</b>	M40x1,5	
	<b>Thread Length (TL)</b>	9,0 mm	
	<b>Ø (D)</b>	48,5 mm	
<b>Clamping Range Outer Sheath Ø min - max</b>		19,0 - 28,0 mm	
<b>Shield Diameter Ø min-max</b>		17,0 - 25,0 mm	
<b>Spanner Width</b>	<b>Cap</b>	43 mm	
	<b>Body</b>	43 mm	
<b>max. Height (H)</b>		48,0 mm	
<b>Part Number</b>		BMEM-E5	

