

FRONT VIEW
(NTS)

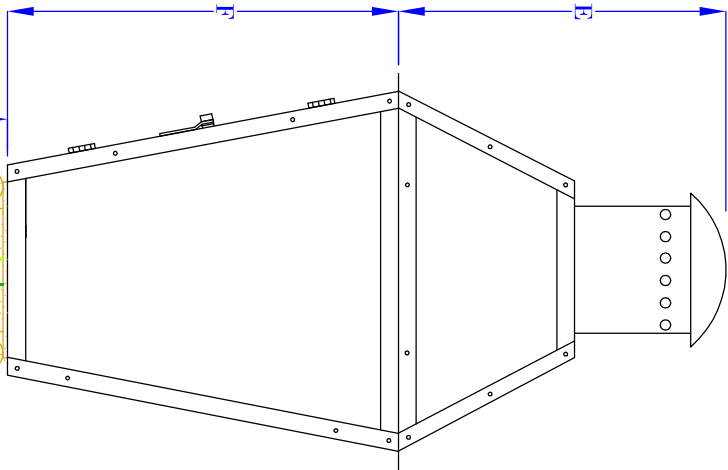

SIDE VIEW
(NTS)

NOTE 4

NOTE 3

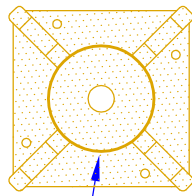

(INSIDE DIAMETER)

BOTTOM VIEW-POST MOUNT
(NTS- BRACKET ONLY)

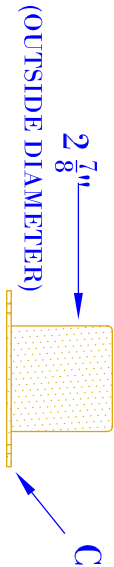

(OUTSIDE DIAMETER)

SIDE VIEW-COLUMN MOUNT ADAPTOR
(NTS- BRACKET ONLY)

- NOTES:
1. MOUNTING HARDWARE SUPPLIED BY OTHERS
 2. FIXTURES ARE HANDCRAFTED. DIMENSIONS MAY VARY PLUS OR MINUS $\frac{1}{4}$ "
 3. ELECTRIC LIGHTS SUPPLIED WITH 18/2 WIRE WITH GROUND
 4. GAS LIGHTS SUPPLIED WITH $\frac{1}{4}$ " GAS NIPPLE AND $\frac{1}{8}$ IP x $\frac{1}{4}$ " GAS LINE ADAPTOR

SIZE:	18"	21"	24"	27"	30"	36"
A:	21 $\frac{3}{4}$ "	23 $\frac{1}{2}$ "	27 $\frac{1}{4}$ "	30 $\frac{1}{4}$ "	33 $\frac{5}{8}$ "	39"
B:	10 $\frac{1}{2}$ "	11 $\frac{1}{2}$ "	13 $\frac{1}{4}$ "	14 $\frac{1}{2}$ "	17 $\frac{1}{2}$ "	21 $\frac{1}{2}$ "
C:	5"x5"	5"x5"	5"x5"	5"x5"	5"x5"	5"x5"
D:	3"	3"	3"	3"	3"	3"
E:	7 $\frac{5}{8}$ "	9 $\frac{3}{8}$ "	12 $\frac{3}{8}$ "	11 $\frac{7}{8}$ "	14 $\frac{1}{2}$ "	17 $\frac{3}{8}$ "
F:	10 $\frac{3}{8}$ "	11 $\frac{1}{8}$ "	12 $\frac{7}{8}$ "	14 $\frac{3}{8}$ "	16 $\frac{1}{8}$ "	19 $\frac{5}{8}$ "

BEVOLO GAS & ELECTRIC LIGHTS

LIGHT:	FRENCH QUARTER		DATE:	APP. BY:	MAJ
BRACKET:	POST MOUNT & COLUMN MOUNT		9-17-2010	REVISION:	4

COPYRIGHT 2009, BEVOLO GAS & ELECTRIC LIGHTS. DRAWINGS & DESIGNS ARE OWNED BY BEVOLO AND REMAIN THE SOLE AND EXCLUSIVE PROPERTY OF BEVOLO GAS & ELECTRIC LIGHTS. DRAWINGS AND DESIGNS SHALL NOT BE DUPLICATED IN WHOLE OR PART.